

364 Diverter Valve

3-Piece Full and Standard Port
ISO 5211 Direct Mount Pad

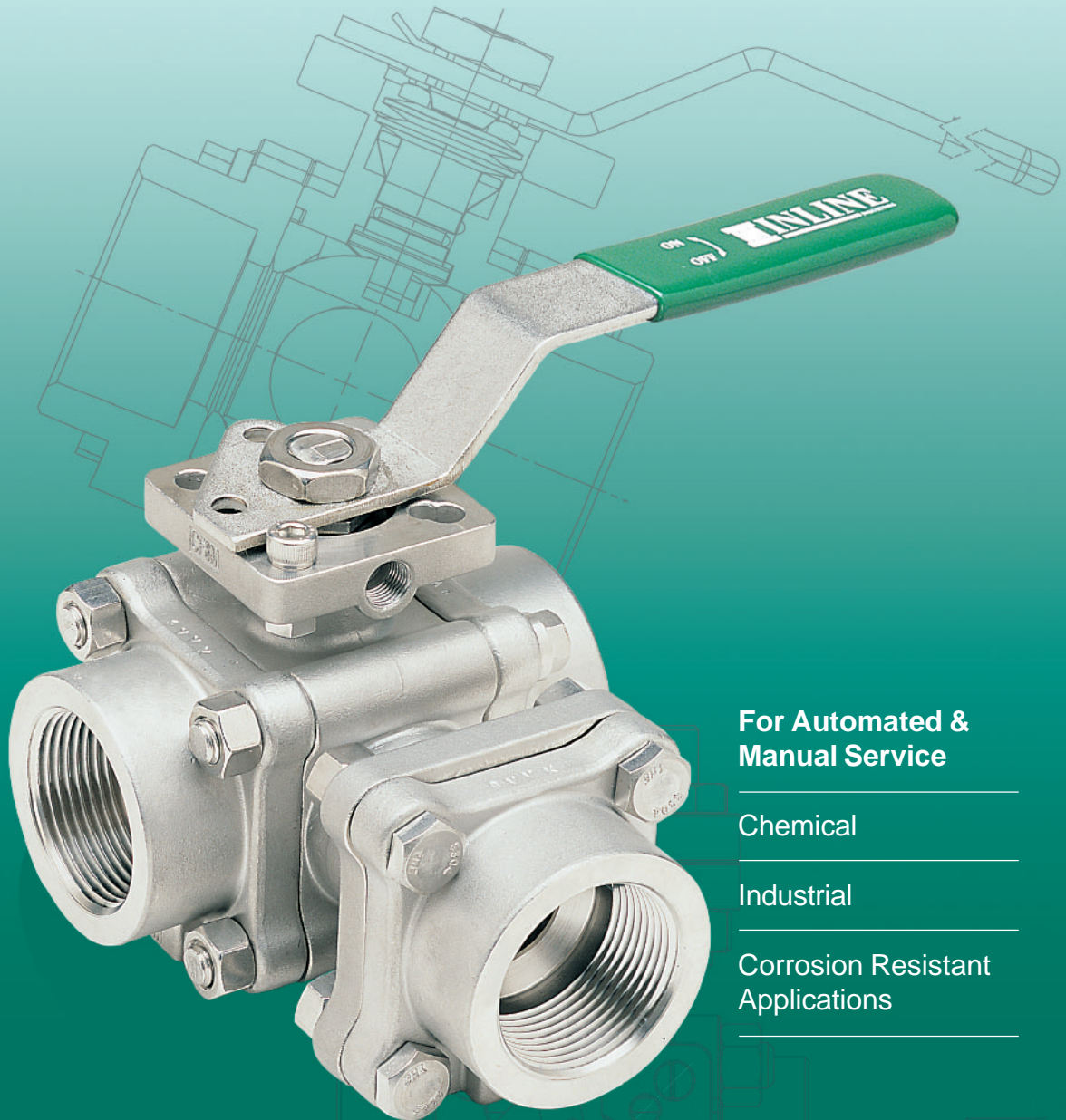

For Automated &
Manual Service

Chemical

Industrial

Corrosion Resistant
Applications

The 364 Series Diverter Valve

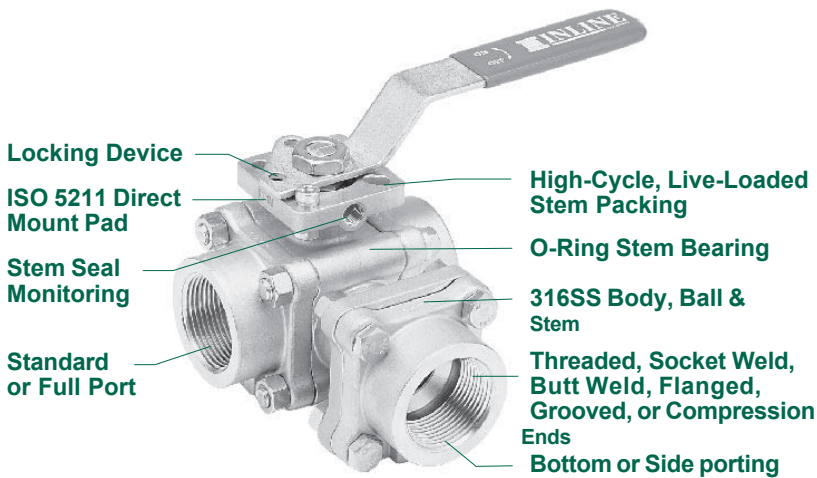

Standard Features and Benefits

- Dual Pattern ISO 5211 Direct Mount Pad**
 No bracket or drive coupling needed for automation
 Dual pattern pad fits a wide range of actuator sizes
 Eliminates exposed moving parts for safer work environment
 Prevents side-loading and premature stem seal failure
- High-Cycle, Live-Loaded Stem Packing**
 Spring energized stem seals self-adjust to compensate for wear, pressure/temperature changes ensuring a leak-tight seal and extending service life
- O-Ring Stem Bearing**
 Maintains stem alignment
 Reduces packing side-loading and wear
 Enhances stem seal performance
- Blow-Out-Proof Stem**
 Stem is bottom loaded to prevent removal when valve is in service
- Universal Valve Body**
 Same center section can be used for both manual and automated service
- Lockout Capability**
 Enables plant personnel to secure valve in open or closed position when manually operated
- Heavy Duty Construction**
 Made to full ANSI B16.34 Class 600 dimensions for trouble-free performance over a wide range of service conditions
- Investment Cast**
 High quality investment castings improve dimensional control and reduce porosity; certified material test reports are available upon request
- Anti-Static Stem**
- Standard Seats and Seals Suitable for 150 PSI Saturated Steam**

Options

- End connections available in NPT, socket weld, butt weld, flanged, compression or grooved, in 316SS or carbon steel
- Jacketed
- Bottom Porting
- High pressure seats and seals
- High temperature seats and seals capable of up to 400 psi of saturated steam

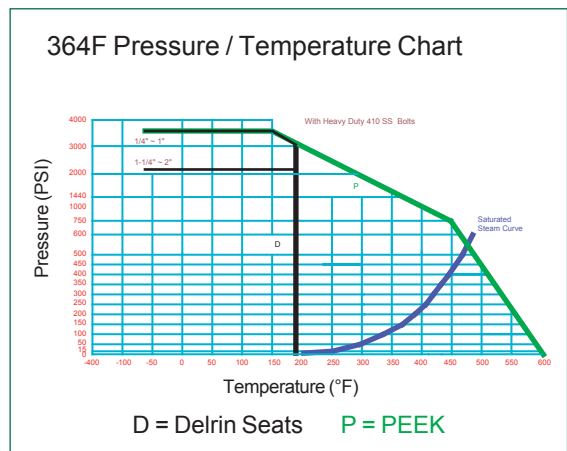
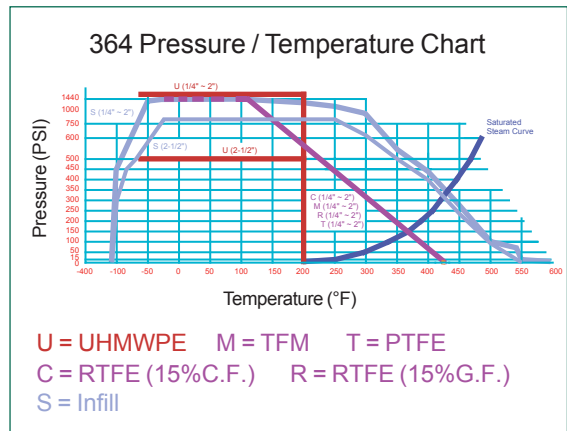

Operating Conditions

- Temperature range:
-20°F ~ 600°F (depending on seats)
- Maximum pressure:
3600 PSI (Class 1500) (1/4" ~ 1")
2160 PSI (Class 900) (1-1/4" ~ 2")

Specifications

- All valves built and pressure tested to ANSI/ASME B16.34, MSS-SP-110 and API 598
- All materials comply with applicable ASTM material specifications
- End connections: All to B16.34; NPT to B1.20.1; socket weld to B16.11; butt weld to B16.25; flanged to B16.5

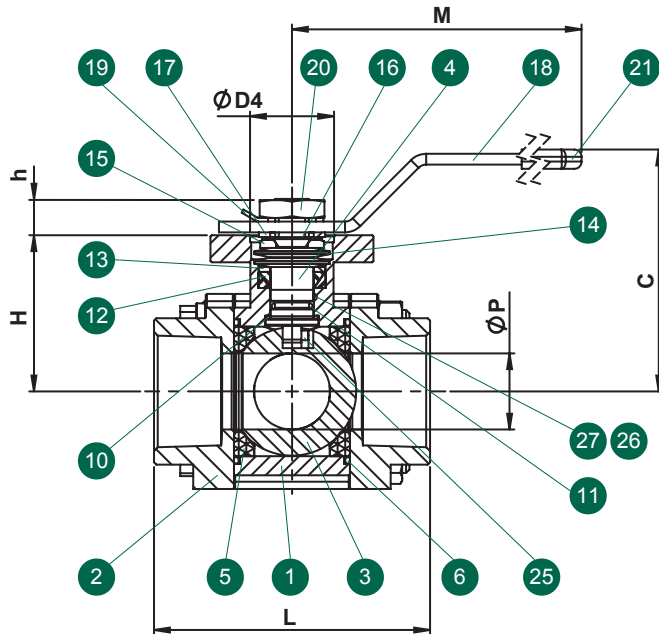
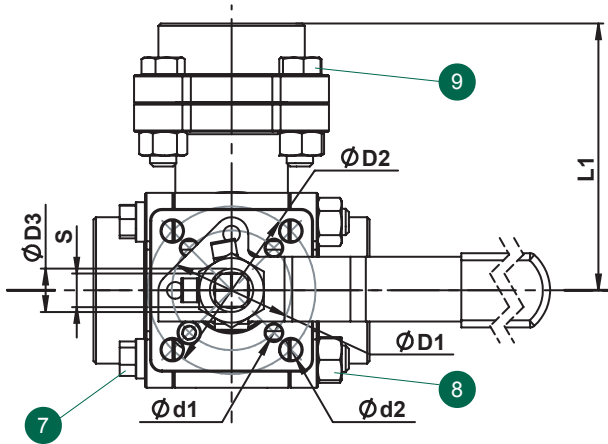

Valve Components			
#	Part Name	Material	Qty.
1	Body	A351 Gr. CF8M	1
2	End Cap	A351 Gr. CF8M	3
3	Ball	316SS	1
4	Stem*	316SS / 17-4	1
5	Seat	TFM	2
6	Body Seal	TFM	3
7	Body Bolt - A	304SS	4
8	Body Nut	304SS	8
9	Body Bolt - B	304SS	4
10	Thrust Washer	PEEK	1
11	Stem O-Ring	Viton 90	1
12	Stem Packing Set	TFM	1
13	Packing Gland	304SS	1
14	Belleville Washer	301SS	4
15	Gland Nut	304SS	1
16	Gland Nut Lock Washer	304SS	1
17	Stem Spacer	304SS	1
18	Handle	304SS	1
19	Handle Nut Lock Washer	304SS	1
20	Handle Nut	304SS	1
21	Handle Cover	Vinyl	1
22	Stop Pin	304SS	1
23	Stop Pin Lock Washer	301SS	1
24	Stop Pin Nut	304SS	1
25	Stem Set Pin	316SS	1
26	Anti-Static Spring	316SS	1
27	Anti-Static Ball	316SS	1

* For Delrin or PEEK seats, the valve stem will be changed to 17-4

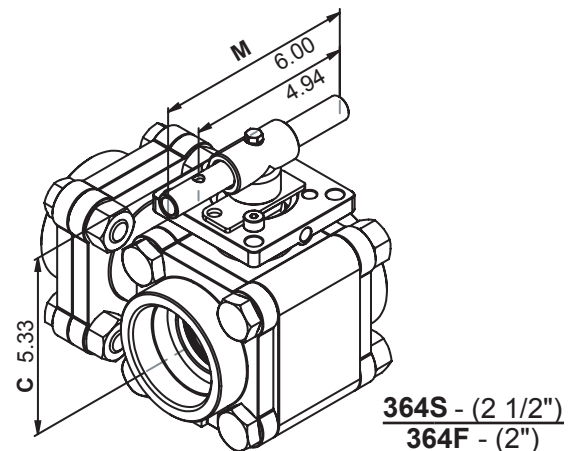
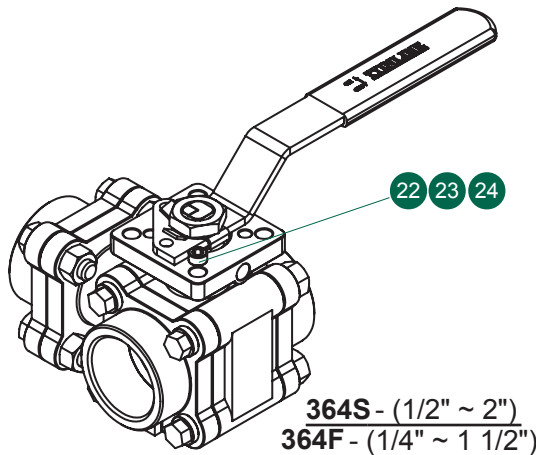

Size			Dimensions (Inches)															
364C	364F	364S	L	L ₁	C	P	M	H	h	D ₁	D ₂	D ₃	D ₄	d ₁	d ₂	S	ISO 5211 Pattern	Wt. (lbs)
1/4 - 3/8	1/4	—	2.57	2.49	3.05	0.44	5.39	1.80	0.38	1.42	1.97	0.47	0.99	0.22	0.28	0.35	F03 / F05*	2.3
1/2	3/8	1/2	2.57	2.49	3.05	0.44	5.39	1.80	0.38	1.42	1.97	0.47	0.99	0.22	0.28	0.35	F03 / F05*	2.3
3/4	1/2	3/4	2.80	2.69	3.14	0.57	5.39	1.89	0.38	1.42	1.97	0.47	0.99	0.22	0.28	0.35	F03 / F05*	3.0
1	3/4	1	3.69	3.43	3.14	0.81	6.69	1.98	0.45	1.65	1.97	0.55	1.18	0.24	0.28	0.43	F04 / F05*	5.2
—	1	1 1/4	4.19	3.88	3.47	1.00	6.69	2.18	0.42	1.65	1.97	0.55	1.18	0.24	0.28	0.43	F04 / F05*	7.5
—	1 1/4	1 1/2	4.54	4.39	3.97	1.25	8.46	2.57	0.60	1.97	2.76	0.71	1.38	0.28	0.35	0.55	F05 / F07*	11.7
—	1 1/2	2	4.98	4.83	4.36	1.50	8.46	2.83	0.60	1.97	2.76	0.71	1.38	0.28	0.35	0.55	F05 / F07*	15.6
—	2	2 1/2	5.87	5.71	5.33	2.00	6.00	3.48	0.79	2.76	4.02	0.87	2.17	0.35	0.44	0.67	F07 / F10*	31.0

Bottom entry drawing available upon request

* Direct mount with stem adapter bushing

Flow Pattern Options

3 Way - Side Entry, L-Port (5L)			3 Way - Side Entry, T-Port (5T)					
Turn	Positions			Turn	Positions			
90°	A & B			90°	B & C			
		Position A	Position B	90°	C & D			
				180°	B & C & D			
3 Way - 180° Bottom Entry Double L-Port (3Y)			3 Way - 180° Bottom Entry L-Port (3A)*			3 Way - Bottom Entry, T-Port (3B)*		
Turn	Positions			Turn	Positions			
90°	A & B			90°	A & B			
		Position A	Position B	90°	B & C			
				180°	A & C			

* Position B, shut-off position is rated at 150 psig maximum differential pressure between bottom inlet and side outlets.

364 Ordering Information

Example: 2" 3-Piece Diverter Standard Port Direct Mount Ball Valve, ISO 5211 Direct Mount Pad with Lever Handle and Locking Device, 316SS Body and Trim, TFM Seats and Seals, NPT Ends, 3-Way Side Entry, L-Port

364S **D** **6** **6** **6** **6** **M** **M** **TT** **5** **L**

Valve Series	Valve Size	Body Material	End Material	Ball Material	Stem Material	Seat	Seal	End Connection ¹	Port Config.	Ball Config.
364S - Standard Port	2 [†] 1/4"	6 - A351 Gr.	6 - A351 Gr.	6 - A351 Gr.	6 - A351 Gr.	M - TFM	M - TFM	T - NPT	3 - 3 Way 180° Bottom Entry	A - Bottom Entry
	3 [†] 3/8"	CF8M	CF8M	CF8M	CF8M	D - Delrin (PTFE Filled Acetal Homopolymer)	T - PTFE	S - Socket Weld	5 - 3 Way Side Entry	Entry
	5 1/2"	(316)	(316)	(316)	(316)	P - PEEK (PTFE and Carbon Filled PEEK)	B - Buna N	1 - Butt Weld Sch. 10		L - Port
364F - Full Port	7 3/4"	3 - A351 Gr.	3 - A351 Gr.		7 - 17-4	S - Infill (Carbon, Carbon Fiber, Ekonol Filled PTFE)	G - Grafoil	4 - Butt Weld Sch. 40		T - Side Entry
364C - Compression	A 1"	CF3M	CF3M			T - PTFE	U - UHMWPE	8 - Butt Weld Sch. 80		T - Port
	B 1 1/4"	(316L)	(316L)			U - UHMWPE	V - Viton (Food Grade)	G - Grooved		L - Side Entry
	C 1 1/2"			2 - A216 Gr.			Q - S Gasket TFE	A - ANSI 150# Flanged		L - Port
	D 2"			WCB				B - ANSI 300# Flanged		Y - Bottom Entry
	E 2 1/2"							P - Compression		B - Bottom Entry
										T - Port

[†] Full Port Only

* Standard Port Only

¹ Socket Weld and Butt Weld ends are A351 Gr. CF3M (316L)

Due to continuous product development, information may change without notice.



Distributed by:

INLINE INDUSTRIES, INC.

4701-A Littlejohn Street
 Baldwin Park, CA 91706
 Tel: (626) 813-6188
 Fax: (626) 813-6186
 www.ballvalve.com
 info@ballvalve.com

© 2010 Inline Industries. All rights reserved.

1009.1